

**MSB-10klb**

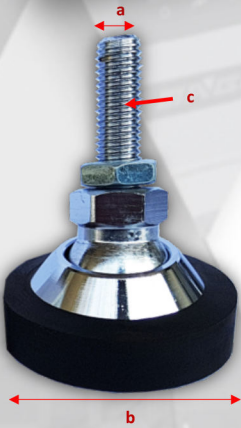

**Dimension of Round foot**

Dimension	a	b	c
Capacity			(threads)
10klb	3/4 - 16UNF	80mm	fine grid

**Dimension MSB-10klb : Unit(mm)**

L	171.5
L1	72.6
L2	38.1
L3	95.3
L4	19
H	38.1
H1	19.1
B	38.1
D1	19.8
D2	19.8
M	3/4-16UNF

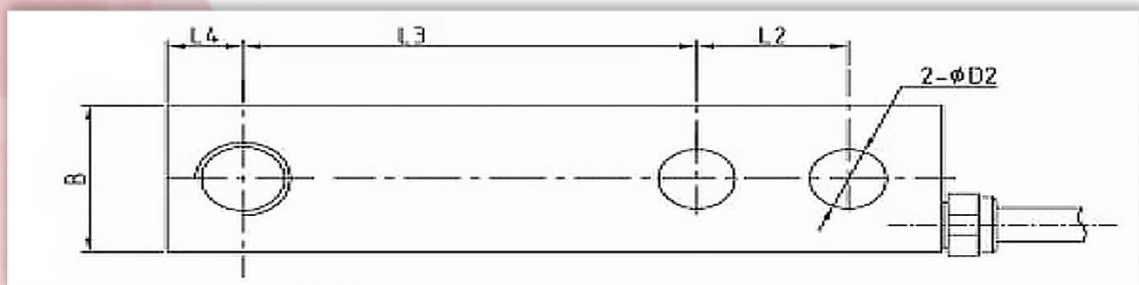
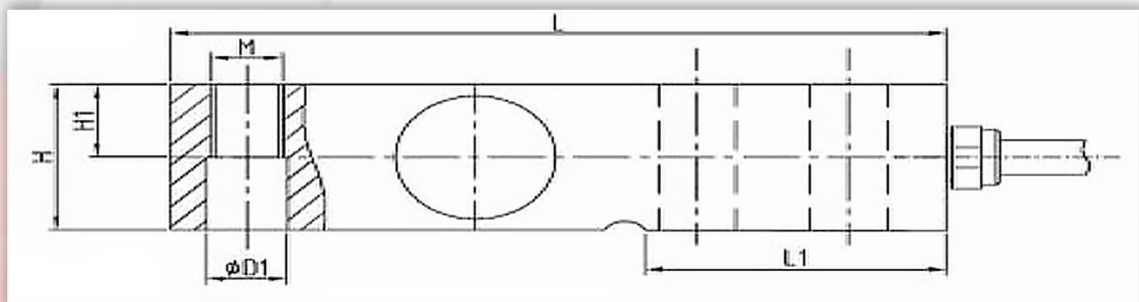

**⊕ Technical Parameter**

- Rated Capacity: 10klb
- Accuracy Class: OIML C3
- NTEP: III, nmax : 5000, Multiple Cell
- Rated Output: 3.0±0.003 mV/V
- Total error: ±0.02%F.S
- Creep(30min): ±0.02%F.S
- Input Resistance: 385±10Ω
- Output Resistance: 351±2Ω
- Operating Temperature: -10~+40°C
- Safe Overload: 150%F.S
- Destructive Load: 200%F.S
- Excitation Recommend: 4~12VDC Max:15VDC
- Cable Length: 1~5m 4 wires with shield
- Exc+(red) Exc-(black) Sig+(green) Sig-(white)
- Construction: Alloy Steel or Stainless steel, IP67
- Application for: floor scales, pallet scales, weighing module etc.

