

**MSB-20klb**



**Dimension of Round foot**

Dimension	a	b	c
Capacity			(threads)
20klb	1-12UNF	80mm	fine grid

**Dimension MSB-20klb : Unit(mm)**

L	225.6
L1	102
L2	50.8
L3	123.9
L4	25.4
H	50.8
H1	25.4
B	50.8
D1	27
D2	27
M	1-12UNF

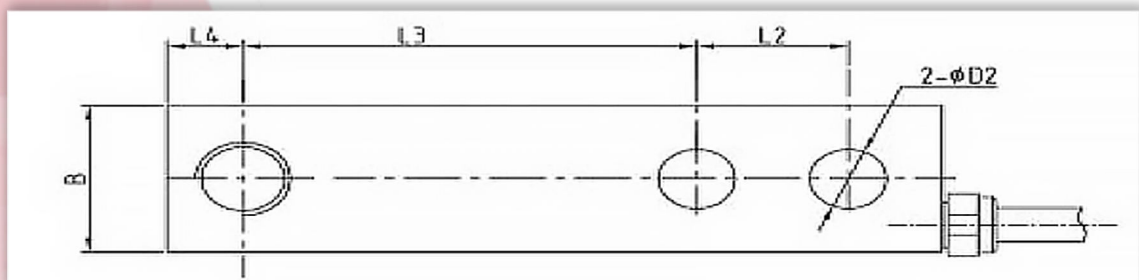
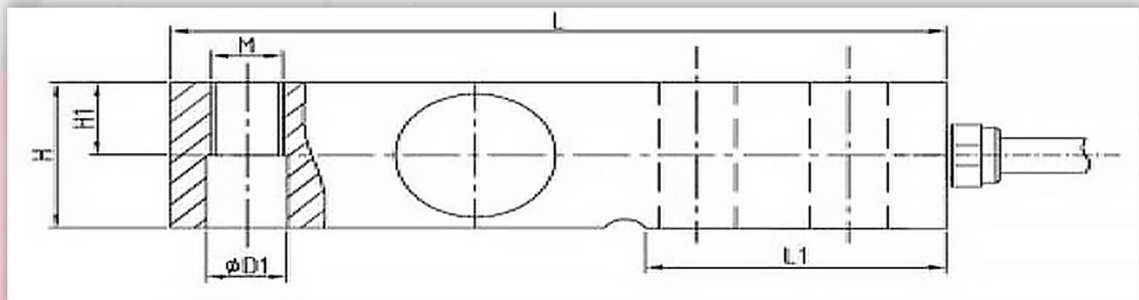

**⊕ Technical Parameter**

- Rated Capacity: 10klb
- Accuracy Class: OIML C3
- NTEP: III, nmax : 5000, Multiple Cell
- Rated Output: 3.0±0.003 mV/V
- Total error: ±0.02%F.S
- Creep(30min): ±0.02%F.S
- Input Resistance: 385±10Ω
- Output Resistance: 351±2Ω
- Operating Temperature: -10~+40°C
- Safe Overload: 150%F.S
- Destructive Load: 200%F.S
- Excitation Recommend: 4~12VDC Max:15VDC
- Cable Length: 1~5m 4 wires with shield
- Exc+(red) Exc-(black) Sig+(green) Sig-(white)
- Construction: Alloy Steel or Stainless steel, IP67
- Application for: floor scales, pallet scales, weighing module etc.

