

MSB-4klb



Dimension of Round foot

Dimension	a	b	c
Capacity			(threads)
4klb	1/2-20UNF	80mm	fine grid

Dimension MSB-4klb : Unit(mm)

L	130
L1	52
L2	25.4
L3	76.2
L4	12.7
H	31.8
H1	16.0
B	31.8
D1	13.5
D2	13
M	1/2-20UNF

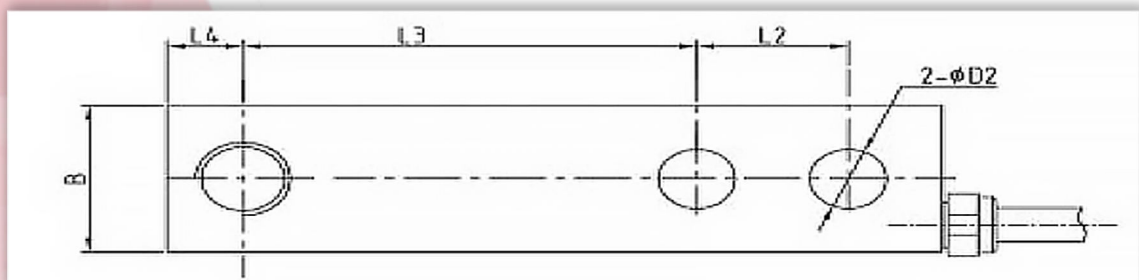
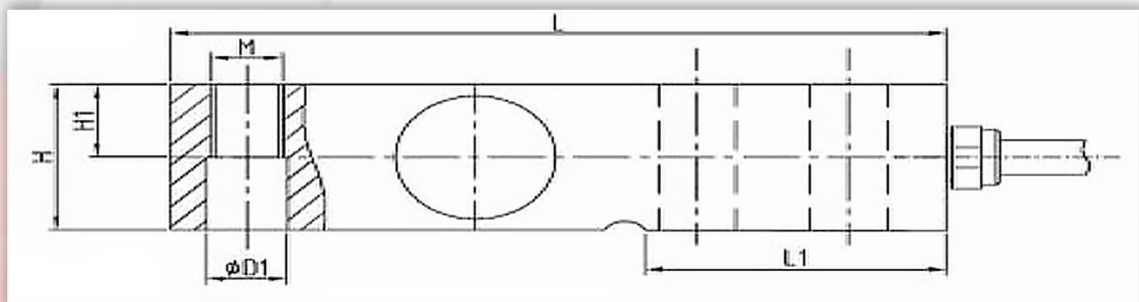

⊕ Technical Parameter

- Rated Capacity: 4klb
- Accuracy Class: OIML C3
- NTEP: III, nmax : 5000, Multiple Cell
- Rated Output: 3.0±0.003 mV/V
- Total error: ±0.02%F.S
- Creep(30min): ±0.02%F.S
- Input Resistance: 385±10Ω
- Output Resistance: 351±2Ω
- Operating Temperature: -10~+40°C
- Safe Overload: 150%F.S
- Destructive Load: 200%F.S
- Excitation Recommend: 4~12VDC Max:15VDC
- Cable Length: 1~5m 4 wires with shield
- Exc+(red) Exc-(black) Sig+(green) Sig-(white)
- Construction: Alloy Steel or Stainless steel, IP67
- Application for: floor scales, pallet scales, weighing module etc.

